

ORDER INFORMATION AND DIMENSION:

Circuits	Part No. (Matte tin-plated)	Dimension		
		A	B	C
2	3001P02 79V	3.00	9.7	14.2
3	3001P03 79V	6.00	12.7	17.2
4	3001P04 79V	9.00	15.7	20.2
5	3001P05 79V	12.00	18.7	23.2
6	3001P06 79V	15.00	21.7	26.2
7	3001P07 79V	18.00	24.7	29.2
8	3001P08 79V	21.00	27.7	32.2
9	3001P09 79V	24.00	30.7	35.2
10	3001P10 79V	27.00	33.7	38.2
11	3001P11 79V	30.00	36.7	41.2
12	3001P12 79V	33.00	39.7	44.2

DESCRIPTION OF ORDER NO.:

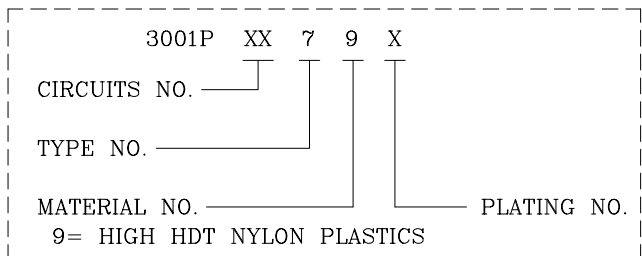

NOTES:

- MATERIAL:**
 BASE: HIGH HDT NYLON 94V-0, BLACK COLOR
 CONTACT PIN: BRASS
 SOLDER PEG: BRASS, MATTE TIN-PLATED
- MATES WITH 3000F SINGLE-ROW SERIES PLUG HOUSING.
- DESCRIPTION OF COLOR CODE:**
 LEGEND: 3001PXX79X-X (-X: COLOR CODE)
 R=RED, E=BLUE, H=GRAY, M=GREEN, S=IVORY (NATURAL)
 I=BRICK RED,
- REPLACEMENT OF HALOGEN-FREE PRODUCT:**
 LEGEND: 3001PXX79X-XNH (NH: HALOGEN-FREE)
 LEGEND: 3001PXX79X-BNH (B=BLACK COLOR)
- PACKING Q'ty= 250 PCS (Embossed Tape Reel in 330 mm Dia. Panel)
- INFORMATION IN THIS DRAWING IS NOT CONSIDERED AS FINAL.

DESCRIPTION OF PLATING CODE:	
V= MATTE TIN-PLATED	A= SELECT GOLD FLASH-PLATED

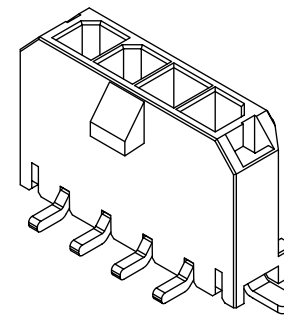
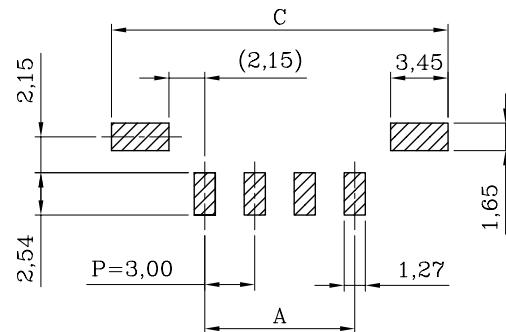
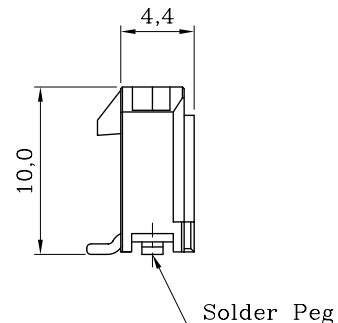
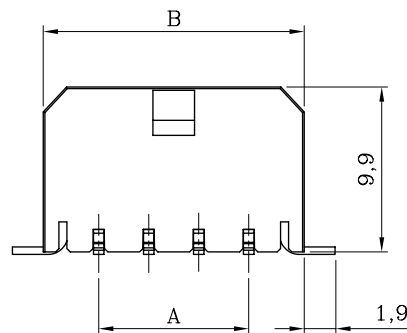
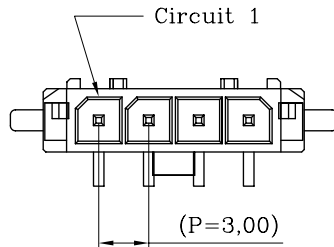

ISOMETRIC VIEW

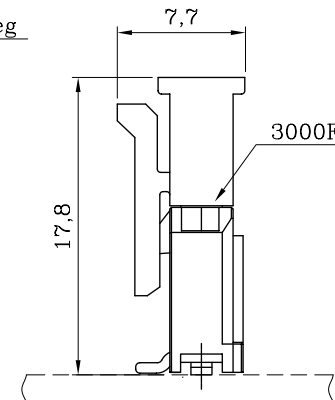

ASSEMBLY LAYOUT

P.C. BOARD LAYOUT
(COMPONENT SIDE)

MATERIAL: SEE NOTES			
FINISH(COLOR): SEE NOTES		GWT 850 °C Rated	
		Sales Drawing	
		聯盈電子股份有限公司 LANDWIN ELECTRONIC CORP.	
		GENERAL TOLERANCE:	PROJECTION: FREE SCALE: FREE UNIT: MM SHEET NO.: 1 / 1 REV: W1
		DRAWN: R.G.	DRAW NO.:
		CHECKED: J.L.Lin	(CQ) 3001PXX79X
		APPD: H.Y.Lin	TITLE:
W1	NEW RELEASE	31-DEC-14'	ANGULAR ±3°
REV.	REVISION RECORD	DATE	DATE 31-DEC-14'